

# BASIC, TRANSLATIONAL & CLINICAL RESEARCH @ BYRD

Asset Map and Blueprint for Strategic Action  
Town Hall Meeting  
September 02, 2008  
Tampa, Florida

## Acknowledgements...

- Byrd Institute
  - Lilly Ho-Pehling
  
- USF
  - Jessica Banko
  - Robert Engelman
  - Christine Tam
  - Matt Anderson
  - Cliff Gooch, Pat Haynie, John Ekarius, Joanne Strobbe and other valuable members of the USF /USF Health Transition Team

## Important Considerations...

- People
  - Faculty, staff, and students
- Place
  - Laboratory and office space
  - Vivarium
- Infrastructure
  - Equipment, core facilities, etc.
- Services
  - Compliance, HR, IT, DSR, DCM, RFM, etc.
- Sound Financial Model

## Asset Map...



## Asset Map..USF Faculty - I

Investigators	Current Level of Funding (\$; millions)			Personnel			
	NIH/Federal	Other	Total	Faculty*	Staff	Grad Students/Post doc	Total
Morgan	1.2	0.01	1.21	01	04	8**	13
Gordon	1.5	0.20	1.70				
Weeber	0.50	0.11	0.61	01	01	04***	06
Dickey	0.75	0.18	0.93	0	04	01****	05
<b>Total:</b>	<b>3.95</b>	<b>0.50</b>	<b>4.45</b>	<b>02</b>	<b>09</b>	<b>13</b>	<b>24</b>

\*excludes the PI's

\*\*3 graduate students/1 Postdocs

\*\*4 graduate students/4 Postdocs

\*\*\*\*Postdocs

## Asset Map...USF Faculty - II

Investigators	Pending Level of Funding (\$; millions)			Vivarium/Animal Needs			
	NIH/Federal	Other	Total	Species	#*	Behav.	Surgery
Morgan	0.40	0.20	0.60	Mice	1000	Y	Y
Gordon	2.20	0.30	2.5				
Weeber	1.4**	0	1.4	Mice	400	Y	Y
Dickey	0	0.30	0.30	Mice	200	Y	Y
<b>Total:</b>	<b>4.0</b>	<b>0.80</b>	<b>4.8</b>	<b>Mice</b>	<b>1600</b>		

\*anticipated census/# of micro isolators

\*\*11th percentile October 2008

## Asset Map...Byrd Investigators - I

Investigators	Level of Funding (\$; millions)			Personnel			
	NIH/Federal	Other	Total	Faculty*	Staff	Grad Students/Post doc	Total
Potter	2.7**	0	2.7	01 (PT)	01	04***	06
Padmanabhan	0	0.24	0.24	0	0	01****	01
Cao	0	0.05	0.05	0	02	0	02
Arendash	0	0.04	0.04	0	03	0	03
Goodwin	0	0.10	0.10	0	01	0	01
<b>Total:</b>	<b>2.7</b>	<b>0.43</b>	<b>3.13</b>	<b>01</b>	<b>07</b>	<b>05</b>	<b>13</b>

\*excludes the PI

\*\*\*3 grad students/1 Postdocs

\*\*\$1.4M is subcontracted

\*\*\*\*grad student

## Asset Map...Byrd Investigators - II

Investigators	Pending Level of Funding (\$; millions)			Vivarium/Animal Needs			
	NIH/Federal	Other	Total	Species	#*	Behav.	Surgery
Potter	0.70	0	0.70	Mice	150	N	N
Padmanabhan	0.45	0	0.45		500		
Cao	0.45	0	0.45		350		
Goodwin	0.45	0	0.45		50		
Arendash	0	0	0		500 <sup>^</sup>		
<b>Total:</b>	<b>2.05</b>	<b>0</b>	<b>2.05</b>		<b>Mice</b>	<b>1550</b>	

\*anticipated census/# of micro isolators

<sup>^</sup>housed in the JHVAMC vivarium

Equipment...

## Asset Map..New Equipment Needs - Immediate

- Thermal Cyclers ( $n=3$ )
- Biological Safety Hood (4 feet; tissue culture)
- Biological Safety Hood (6 feet; surgical)
- Nanodrop (UV Spec)
- Microscope Imaging Workstation
- Liquid Nitrogen Storage
- **Microtome\***, chiller, etc.
- Cryostat
- Bacterial Shaker/Incubator
- Centrifuges (**J6\***, Avanti J20, M70 all with rotors)
- Stainless steel tables for behavior equipment
- Viral Vector Core
- Electrophysiology Core
- Tables for the common equipment rooms
- Portable Air Compressor

\*possibly relocated from MDC

## Asset Map..New Equipment Needs Near Future

- Multiphoton Confocal (~\$600K)
- Brain Imaging
  - 7T fMRI
  - PET, SPECT, etc.

## Anticipated Future Growth

- Recruitment of Following Investigators:
  - Thomas Wisniewski (Visiting September 3-4, 2008) and Martin Sadowski from NYU
  - David Kang from UCSD
  - Madepalli K. Lakshmana from UCSD
  - Director, Suncoast Alzheimer's & Gerontology Center
  - Chief Scientific Officer
- Same-store growth
  - 15-20%/year for the next 4-5 years

## Space Allocation

## Vivarium

*Due to Limited  
Availability of Space  
Initially, Housing will  
be Confined to Mice*

## Vivarium - Operations

- Byrd facility is part of USF AAALAC accreditation and will be managed by the Division of Comparative Medicine and its staff
- Appointed Liesl Wiesen, MS., RLATG., as Manager of the Byrd Vivarium - effective Wednesday, **August 27, 2008**
  - Currently, Manager of JAHVAMC Animal Facility
- First colony of animals will be relocated the week of September 15, 2008
- Facility will be fully-functional as of October 15, 2008

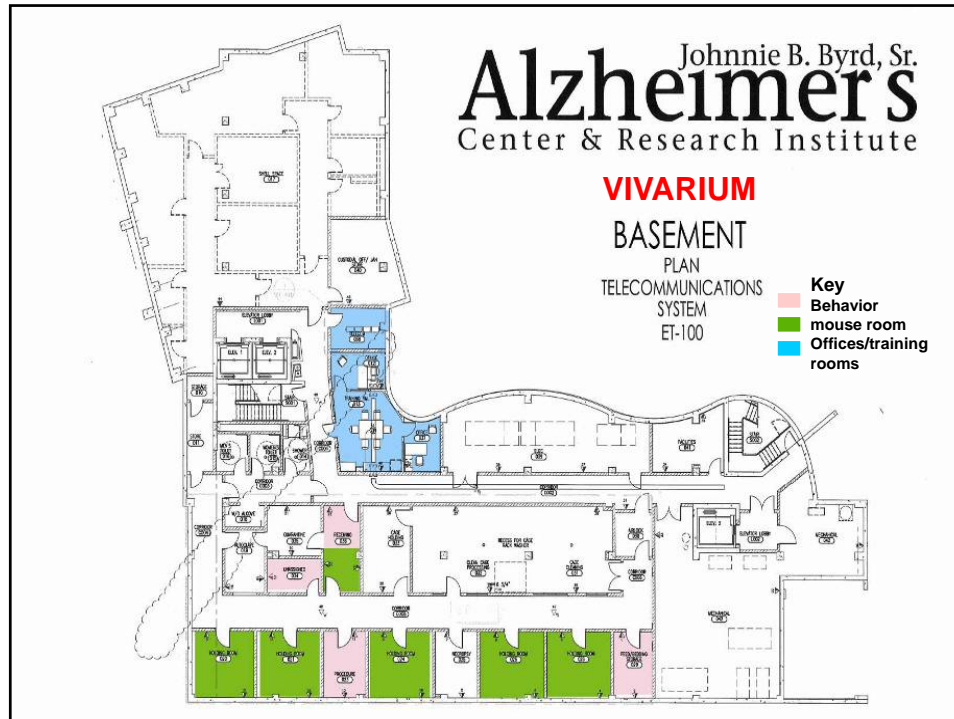

## Vivarium - Space

- **Holding Rooms: 020, 021, 024, 026, 028:**
  - Mouse holding rooms fit comfortably 5 racks/room (could accommodate 6 racks/room). Each rack holds 96 mouse isolation boxes.
  - **Total accommodations**
    - 2400 boxes (5 racks/room)
    - 2880 boxes (6 racks/room)
  
- **Behavioral Testing Rooms:**
  - Dedicated: 034, 036, 029
  - Overflow: 023
  - Room 034 will house dry maze equipment (zero maze, t maze, elevated plus, etc)
  - Room 036 will house water maze and short-term animal housing
  - Room 029 will house sound-sensitive and invasive equipment (fear conditioning, acoustic startle, PPI, hot plate, tail flick etc)
  - Room 023 will remain a procedure room with the ability for overflow water maze and/or portable assays (rotarod)

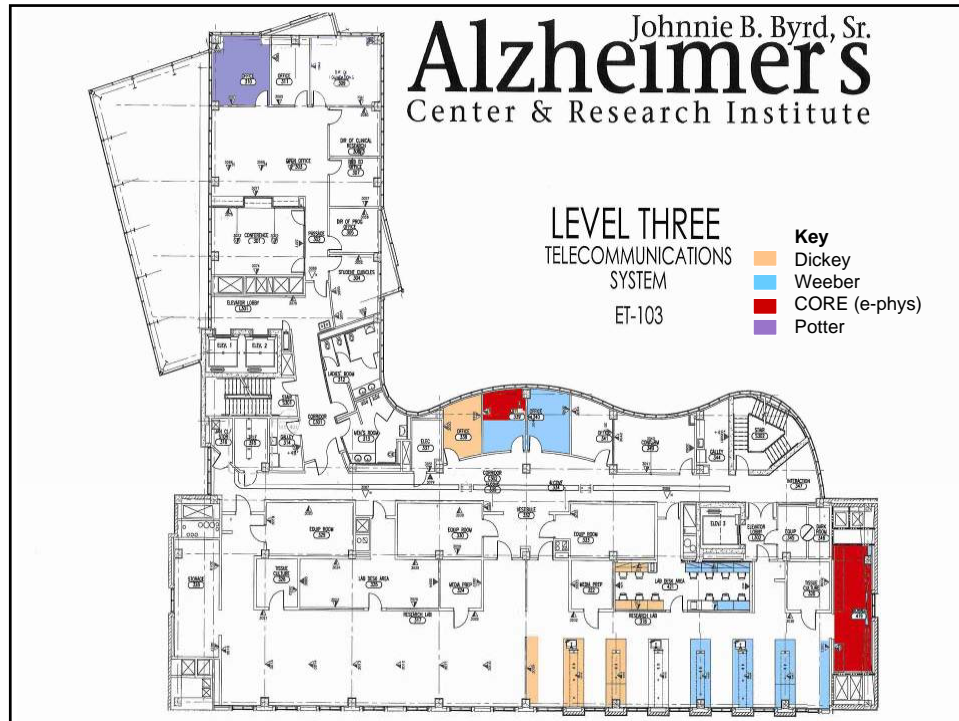

## Allocation of Research Space- *Level 3*

- **Offices:**
  - Weeber 340 and 339 (half)
  - Wu 339 (half; Director of EP Core)
  - Dickey 338
  - Potter 310
- **Laboratory:**
  - Weeber: Three Bays 318; 6 Lab Desks 321
  - Dickey: Two Bays 318; 5 Lab Desks 321
- **Electrophysiology Core 319**

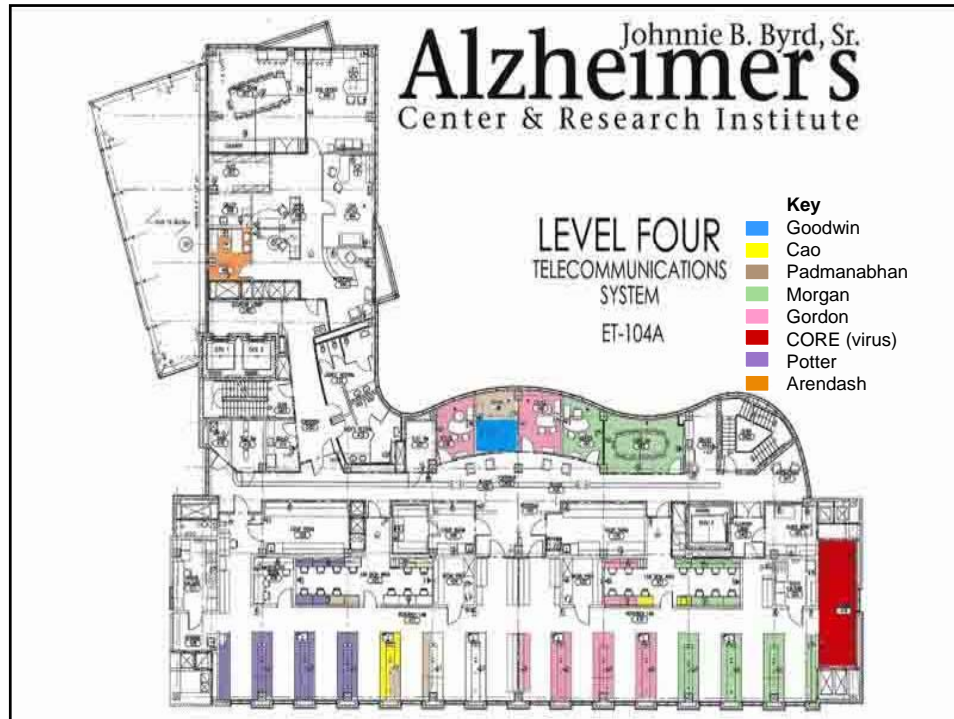

## Allocation of Research Space - *Level 4*

- **Offices:**
  - Morgan 441, 443
  - Gordon 438, 440
  - Padmanabhan and Goodwin 439
  - Arendash 409
- **Laboratory:**
  - Morgan: 3 Bays 418; 1 Equip Bench 418; 7 desks 421
  - Gordon: 3 Bays 418; 1 Equip Bench 418; 4 desks 421
  - Potter: 3 Bays 417; 1 Equip Bench 417; 5 desks 425
  - Cao: 0.75 Bay 417; 2 desks 421
  - Padmanabhan: 0.75 Bay 417, 2 desk 425
  - Goodwin: 0.5 Bay 417; 1 desk 425
- **Viral Vector Core 419**

## Common Space - Levels 3 & 4

- Conference Rooms
- Media Preparation Rooms
- Microscopy Rooms
- Tissue Culture Rooms
- Storage Rooms (except 319 and 419)
- Common Equipment Rooms

## Anticipated Renovations

- **Vivarium**
  - Air handling for animal housing on 036
  - Closure of the east and north doors of room 036 so that this room can be used for behavioral testing and animal housing
- **Level 3**
  - Air handling in equipment room
  - Viral Vector Core - add door, pull utilities, etc.
- **Level 4**
  - Air handling in equipment room
  - Electrophysiology Core – add door, pull utilities, etc.

## Anticipated Cost

Activity	Approximate Cost (\$)
EQUIPMENT	300,000
RENOVATION	? (waiting on Turner estimate)
CO-LOCATION	20,000
CORES (Electrophysiology/Viral Vector)	425,000
TOTAL:	

## Growth Capacity - Level 3

- Research Lab 317 (six bays and two equipment benches)
- Room 325 (13 lab desk spaces)
- Storage Room 328
- Media Room 326
- Tissue Culture Room 324
- Equipment Rooms 329 and 330
- Offices 303, 304, 305, 307, 308, 310, 311, 341

## Growth Capacity - Level 4

- Research Lab 417 (1 bay and one equipment bench)
- Room 425 (5 lab desk spaces)
- Offices:
  - Executive: 406, 404
  - Other: Cubicles

## Anticipated Expansion Projects

- Priority I:
  - Expansion of Vivarium
  - Estimated Cost: \$1 million
- Priority II:
  - Build out of level 5 (additional ~5000 ft<sup>2</sup> NAS Lab)
  - Estimated Cost: \$3.5 million (with equipment)
- Priority III:
  - Build out of level 6 (additional ~5000 ft<sup>2</sup> NAS Lab)
  - Estimated Cost: \$3.5 million (with equipment)

## Basic & Translational Research

Phase III (*Completion Date: December 12, 2008*)

- Purchase and/or relocate essential equipment (September 15, 2008)
- Complete space renovations/modifications (September 30, 2008)
- Complete co-location of faculty, staff, and students
  - Phase I: Weeber and Dickey; September 30, 2008
  - Phase II: Morgan and Gordon; December 15, 2008
- Relocate animals
  - Phased with PI co-location

Students...

## Students @ Byrd...

- Continue to support the mission of engaging undergraduate, graduate and professional students in discovery and innovation
- Continue to provide research opportunities to postdoctoral fellows and residents
- Support for these students will emanate from multiple resources including that of Byrd, USF, USF Health, Investigators, etc.

## Graduate Students @ Byrd...

- Four students (Mentor: Potter [ $n=3$ ]; Padmanabhan [ $n=1$ ])
- Currently funded through Byrd resources
- Much higher stipend as compared to their peers in the COM
- Three of four students will graduate in Spring 2009; one student to graduate in Spring 2012
- Preserve stipend, benefits, and tuition for current AY
- As of Fall 2009, stipends, benefits, and tuition revert to the level of their peers in the COM
- All new students will have stipends, benefits, and tuition waivers comparable to their peers in the COM

# Scientist/Faculty...

## Scientists @ Byrd...I

- Dr. Hunt Potter:
  - Continue his appointment as Eric Pfeiffer Chair in Alzheimer's Research, Department of Molecular Medicine
  - Serve as a Senior Scientist at Byrd
  - Continue as the Director of ADRC
  - Provided with adequate start-up funds and lab/office space to continue with his research endeavors
  
- Dr. Jaya Padmanabhan:
  - Appointed as an Assistant Professor (Research-track), Department of Molecular Medicine effective September 02, 2008
  - Provided with adequate start-up funds and lab/office space to continue with her research efforts

## Scientists @ Byrd...II

- Dr. Chuanhai Cao:
  - Appointed as an Assistant Professor (Research-track), Department of Molecular Pharmacology & Physiology effective September 02, 2008
  - Provided with adequate start-up funds and lab/office space to continue with his research efforts
  - Mentor: Dr. David Morgan
- Dr. Bonnie Goodwin:
  - Appointed as an Assistant Professor (Research-track), Department of Molecular Medicine effective September 02, 2008
  - Provided with adequate start-up funds and lab/office space to continue with her research efforts
  - Mentor: Dr. Hunt Potter

## Scientists @ Byrd...III

- These are time-limited appointments with potential for transition to tenure-track (Exception: Dr. Potter)
- Similar to their peers in the COM, clearly defined performance-metrics detailed in their letter of appointment which include:
  - Stringent annual evaluations
  - Obtainment of extramural funding (preferably NIH) by year 3 of appointment
  - Enhanced research productivity as evidenced by growth in funding, publications, successful student mentorship, etc.
  - Continued support of Byrd's mission of finding a cure for Alzheimer's
  - Enhanced interdisciplinary collaborations with colleagues at USF, USF Health and other institutions

## Other Personnel...

- All staff/technician retained in the lab become USF employees. This is important since:
  - It gives them job security
  - Minimizes compliance-related challenges
  - Equalizes their compensation, appointment, etc., to that of their peers in the COM
  - Creates a sense of "community" in the labs/office at Byrd

## Clinical Research...

## Clinical Research...

- Includes, NIH-sponsored clinical research as well as industry-sponsored clinical trials
- Greatest potential for growth at Byrd
- Allows for expeditious “translation” of bench-bedside (and reverse) discoveries @ Byrd
- With >900 recruited human research subjects, this is a very important component of Byrd’s mission and the Florida ADRC

## Eric Pfeiffer Suncoast Alzheimer’s and Gerontology Center...I

- Interim Director: Dr. Amanda Smith
- Personnel ( $n=10$ ):
  - Physicians ( $n=2$ )
  - Study Coordinators ( $n=3$ )
  - Education Coordinators ( $n=2$ )
  - Other ( $n=3$ )
- Primary Expertise:
  - Clinical Trials
  - Education and Community Outreach
- Co-locate to Byrd
  - Effective Date: **On or before October 12, 2008**

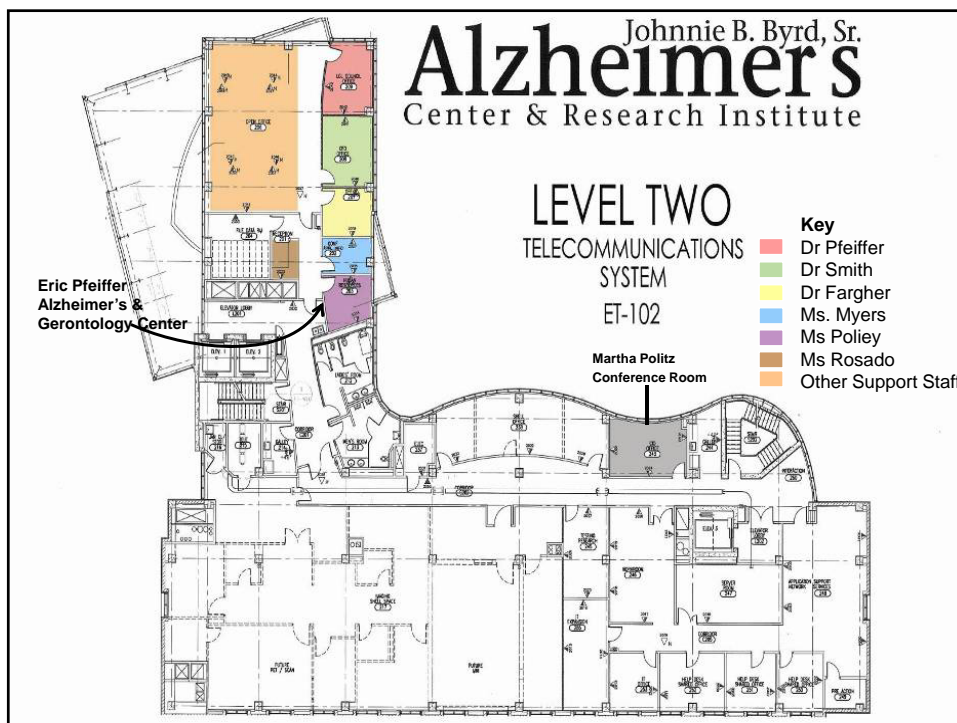
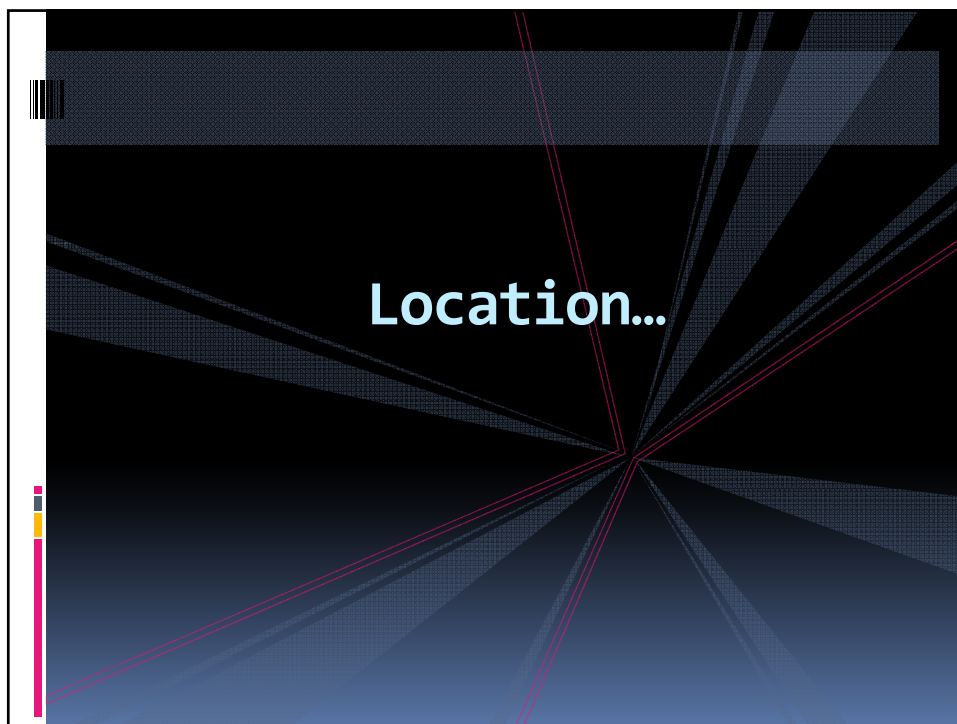

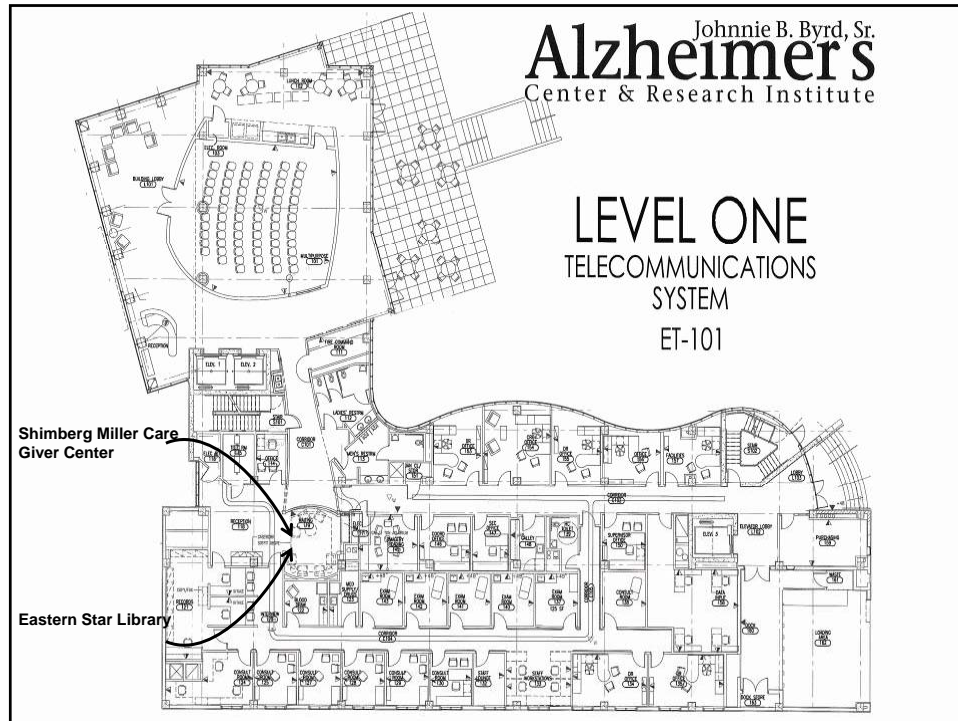

## Clinical Research @ Byrd

- Initiated an analysis of existing capacity @ Byrd
- Developing a model for integration of all clinical research activity @ Byrd
- Implementation Date:
  - **On or before October 15, 2008** (timed with co-location of Suncoast)

## Take Home Message...I

- ALL investigators @ Byrd will become faculty in the COM, USF Health - effective **September 02, 2008**
- All research staff @ Byrd **retained by the faculty** will become USF employees
  - Effective Date: **On or before September 12, 2008**
- Graduate students will continue to retain their existing compensation/tuition package for AY 2008-09
  - In AY 2009-10, the stipend and tuition benefits will revert to their peers in the COM
  - All new incoming students will have stipend and tuition benefits comparable to their peers in the COM
  - Stipend/tuition for graduate students will emanate from mentor's extramural awards; a practice comparable to their peers in the COM

## Take Home Message...II

- A team of four investigators with NIH-funded research in the area of Alzheimer's will co-locate from the COM to Byrd. They include:
  - Dr. Dave Morgan
  - Dr. Marcia Gordon
  - Dr. Edwin Weeber
  - Dr. Chad Dickey
- Collectively, they bring ~\$5 million of existing (mostly NIH) funding and ~29 faculty, staff, and students to Byrd
- They have ~\$5 million of potential funding in the pipeline (predominantly NIH) with tremendous promise for growth and collaboration
- Co-location will start effective immediately and conclude by **December 15, 2008**

## Take Home Message...III

- Started the process of creating a functional vivarium
  - Appointed Facility Manager – August 27, 2008
  - Initiated the process of undertaking minor renovations
  - Transfer of animals will be phased with PI co-location
  - **Fully functional: October 15, 2008**
  
- Three NEW cores will be established @ Byrd:
  - Viral Vector Core (Floor Level IV)
  - Electrophysiology Core (Floor Level III)
  - Behavioral Core (Vivarium)
  - **Completion Date: On or before December 15, 2008**

## Take Home Message...IV

- Effective **August 27, 2008**, ALL new recruits (faculty, staff, and students) @ Byrd will be employees of USF/USF Health
  
- All existing grants/contracts for sponsored research @ Byrd will transition to USF in faculty's respective departments
  - Completion date: **On or before September 30, 2008**
  
- MOU is currently being drafted for funds flow between Byrd and USF (and reverse) to offset research-related expenses; until then, an account has been established at USF Health to pay for these expenses

## Take Home Message...V

- Eric Pfeiffer Suncoast Alzheimer's & Gerontology Center will co-locate to Byrd
  - Completion date: **On or before October 10, 2008**
- Integration of all clinical research activity @ Byrd
  - Completion date: **On or before October 10, 2008**

## Occupancy Analysis...

FLOORS	RESEARCH-RELATED OCCUPANCY (%)	
	CURRENT	DECEMBER 15, 2008
VIVARIUM*	0	100
FLOOR I	15-20	60-75
FLOOR II*	0	40
FLOOR III	0	50
FLOOR IV	40-45	100
FLOOR V	Shelled Space for future growth & expansion	
FLOOR VI		

\*Built out space only; shell space available for future growth & expansion

## Other Issues...

### ADRC...I

- For year 4 and 5 of award, preserve funding for committed Byrd match: FY08-09: \$1,140,279; FY 09-10: \$1,132,853
- Reassure all Core Directors and PI's (internal and external), that the Byrd match funding will be forthcoming for years 4 and 5 of award
- Initiate a very deliberate and strategic programmatic review of ADRC grant with a view towards the following:
  - Identify areas of strengths and weaknesses
  - Define and implement a strategy to address areas of concern and preserve and enhance our strengths
  - Review the validity and the utility of various cores and identify what needs to be retained and/or amplified
  - Identify new sites/partners (such as UM, etc.)

## ADRC...II

- Identify matching funds (in-kind and recurring) for next five years (FY10-15) of competitive renewal
- Submit a competitive renewal application in May 2009
- Ultimate Goal: **RETAIN THIS AWARD AT USF**

RESEARCH SERVICES  
@  
USF/USF HEALTH

## Research Compliance - I

### *Division of Research Integrity & Compliance, USF*

- Biosafety
- HIPAA
- Human Subject Research Protection (IRB, etc.)
- Radiation Safety
- IACUC
  
- Contact Information:
  - Caroline Fultz-Carver, PhD., Interim Director
  - Mailing Address: 12901 Bruce B. Downs Blvd., MDC35, Tampa, FL 33612-4799
  - Office Location: 3702 Spectrum Blvd., Suite 155, USF Research Park Tampa, FL
  - Phone: (813) 974-9312 Fax: (813) 974-5618
  - E-mail: [cfcarver@research.usf.edu](mailto:cfcarver@research.usf.edu)
  - Website: <http://www.research.usf.edu/cs/>

## Research Compliance - II

### *Division of Comparative Medicine, USF*

- Husbandry Services
- Veterinary Services
- Operational Oversight of Byrd Vivarium
- USF Facility
  
- Contact Information:
  - Liesl Wiesen, MS, RLATG, Manager, Byrd Vivarium
  - Location: Byrd Vivarium
  - Phone: (813) 319-5111
  - E-mail: [lwiesen@admin.usf.edu](mailto:lwiesen@admin.usf.edu)
  - Website: <http://www.research.usf.edu/cm/>

## Research Compliance - III

### *Division of Research Compliance, USF Health*

- Conflict of Interest - Human Research
- Contact Information:
  - Camille McWhirter, JD., Director
  - Location: CMS 3059
  - Phone: (813) 974-6676
  - E-mail: [cmcwhirt@health.usf.edu](mailto:cmcwhirt@health.usf.edu)
  - Website: <http://health.usf.edu/research/compliance/index.htm>

## Research Compliance - IV

### *Environmental Health & Safety*

- Hazardous Waste Management
- Chemical
- Biohazardous
- Pharmaceutical
- Laboratory Safety
- Hazardous Inventory Tracking System (HITS)
- Workers' Compensation
- Fire Safety
- Asbestos Management
- **Contact Information:**
  - Web Address: <http://www.usf.edu/eh&s>
  - Main Tel: (813) 974-4036
  - Sandy Cooper, PhD, Interim Director
  - E-mail: [scooper@admin.usf.edu](mailto:scooper@admin.usf.edu)
  - Tel: (813) 974-0868

## Other Research-related Services - I

### *Office of Research Services, COM*

- Sponsored Research Administration - COM
- Core Facility and Equipment Management
- Research-Related Support
  
- Contact Information:
  - Jessica L Banko, PhD, Director
  - Location: MDC 2305
  - Phone: (813) 974-3823
  - E-mail: [COMResearch@health.usf.edu](mailto:COMResearch@health.usf.edu)
  - Website: <http://health.usf.edu/medicine/research/>

## Other Research-related Services - II

### *Division of Sponsored Research – USF*

- Sponsored Research Administration - USF
- Pre-Award Management
- Post-Award support
  
- Contact Information:
  - Keith Anderson
  - Location: 3650 Spectrum Blvd, Suite 150
  - Phone: (813) 974-6329
  - E-mail: [kanderson@research.usf.edu](mailto:kanderson@research.usf.edu)
  - Website: <http://www.research.usf.edu/sr/>

## Other Research-related Services - III

### *Research Financial Management – USF*

- Sponsored Research Financial Administration - USF
- Post-Award Management
- Effort Reporting
- Cash Management
  
- Contact Information:
  - Contract & Grant – Doreen Shockley
  - Location: 3702 Spectrum Blvd, Suite 135
  - Phone: (813) 974-6921
  - E-mail: [dshockley@admin.usf.edu](mailto:dshockley@admin.usf.edu)
  - Website: <http://usfweb.usf.edu/controller/research/>
  
  - Compliance, Audits & Effort Reporting – Beth Dhondt
  - Location: 3702 Spectrum Blvd, Suite 135
  - Phone: (813) 974-6096
  - E-mail: [bdhondt@admin.usf.edu](mailto:bdhondt@admin.usf.edu)
  - Website: <http://usfweb.usf.edu/controller/research/>

## Other Research-related Services - IV

### *Office of Clinical Research, COM*

- Pre- and Post-Award Clinical Trial Management
- IRB Protocol Development Support
  
- Contact Information:
  - Patricia Emmanuel, MD, Associate Dean
  - **Catherine Jahrsdorfer, R.N., B.S.N., Director**
  - Location: CMS 3066
  - Phone: (813) 396-9172
  - E-mail: [cjahrsdo@health.usf.edu](mailto:cjahrsdo@health.usf.edu)
  - Website: <http://health.usf.edu/research/ocr/index.htm>

## Other Research-related Services - VI

### *Division of Patents and Licensing – USF*

- Technology Transfer
- Contact Information:
  - Valerie McDevitt, JD, Director
  - Location: 3802 Spectrum Blvd, Suite 100
  - Phone: (813) 974-0994
  - E-mail: [patents@research.usf.edu](mailto:patents@research.usf.edu)
  - Website: <http://www.research.usf.edu/pl//>

## Graduate Education...

### *Office of Graduate and Postdoctoral Affairs, COM*

- Graduate Student Recruitment, Enrollment and Management
  - PhD, MD-PhD, MA/MS, Graduate Certificate
- Postdoctoral Development
- Contact Information:
  - Michael Barber, DPhil, Associate Dean
  - Location: MDC 2307
  - Phone: (813) 974-4181
  - E-mail: [mroth@health.usf.edu](mailto:mroth@health.usf.edu)
  - Website: <http://health.usf.edu/medicine/graduatestudies/index.htm>

## Library Services...

- All personnel at Byrd will have unlimited access to library services (electronic and print) offered by Shimberg Health Sciences Library and USF Library System
  - Provide IP ranges of hardware at Byrd to vendors - completed
  - Access testing with Byrd IT staff - in progress
- For remote access to some electronic resources at Shimberg Library
  - Immediately after obtaining USF Health e-mail accounts
- For remote access to all USF Library System and specific databases (such as Springer, Nature, etc.)
  - Immediately after obtaining USF ID cards
- **Contact Information:**

Rose Bland, MA, AHIP, Assistant Director, Technology & Access Services  
 Tel: (813) 974-2289  
 E-mail: [rbland@healthlib.usf.edu](mailto:rbland@healthlib.usf.edu)

John Scott, Network Administrator  
 Tel: (813) 974-6860  
 E-mail: [joscott@healthlib.usf.edu](mailto:joscott@healthlib.usf.edu)  
 Website: <http://library.hsc.usf.edu/>

## Other Services...I

- **Human Resources:**
  - Nancy Wisgerhof
    - E-mail: [nwisger@admin.usf.edu](mailto:nwisger@admin.usf.edu)
    - Tel: (813) 974-3595
    - Website: <http://usfweb2.usf.edu/HR/>
- **Faculty Affairs:**
  - Diane Laya
    - E-mail: [dlaya@health.usf.edu](mailto:dlaya@health.usf.edu)
    - Tel: (813) 974-7728
    - Website: <http://health.usf.edu/facultyaffairs/index.htm/>
- **Other:**
  - Christine Tam (HR-related matters):
    - E-mail: [ctam@health.usf.edu](mailto:ctam@health.usf.edu)
    - Tel: (813) 396-9109
  - Matt Anderson (Research Finance)
    - E-mail: [manders1@health.usf.edu](mailto:manders1@health.usf.edu)
    - Tel: (813) 974-2891

## Other Services...II

- Information Technology
  - Tim Bulu
  - E-mail: [tbulu@health.usf.edu](mailto:tbulu@health.usf.edu)
  - Tel: (813) 974-6288

## Core Facilities - COM

- Lisa Muma Weitz Advanced Microscopy & Cell Imaging
- Fred Wright Jr. Laboratory for Cell Isolation & Analysis
- Murine Neurobehavioral Laboratory
- Phyllis & Walter Mason Laboratory for Small Animal Imaging and Advanced Cardiovascular research
- Human Functional Performance Laboratory
- Mouse Models Core
- USF Hyperbaric Biomedical Research Laboratory
- Biosafety Level 3 Laboratory
- Biostatistics and Medical Writing Core
- <http://hsc.usf.edu/corefacilities/index.htm>

## Contact Information:

- **Abdul S. Rao, M.D., M.A., D.Phil**  
Professor of Surgery & Molecular Medicine  
Senior Associate Vice President - USF Health  
Director, School of Biomedical Sciences, College of Medicine  
Medical Director – Clinical Research  
Tampa General Hospital  
University of South Florida - Health  
Suite 401 JBAI  
Tel: (813) 319-4605  
Fax: (813) 866-1601  
E-mail: [arao@health.usf.edu](mailto:arao@health.usf.edu)  
Website: <http://research.health.usf.edu/>

## What Next...

- Finalizing a five-year budget for research expenses @ Byrd
- Developing a five-year strategic growth plan for research, clinical services, and education @ Byrd
  - Recruitment of additional faculty, staff, and students
  - Build out of vivarium and Floors 5 and 6
  - Equipment and infrastructure enhancements, etc.
- Developing an Integrated plan for patient care @ Byrd
- **Submit a competitive ADRC application in May 2009**

## What Next...

- Town Hall Meeting Friday September 12, 2008
- Topics to be addressed:
  - Ongoing updates about Basic/Translational Research
  - Strategic Plan for Clinical Research